

MACHINE MODEL

XSMART3

Automatic bandsaws for every working environment

Short description

XSMART3 is an automatic double column bandsaws for straight cuts and totally managed by CNC with 7" touch screen display, easy and intuitive interface. Fully protected by carters to provide maximum security to the user, it's an easy to use professional tools that can be installed in every environment and mechanic workshop.



Cutting capacity at 0°	Round 310 mm. - Square: 310mm - Rectangular: 340x310mm
Cutting capacity at 0° with solids (C45)	250 mm
Cutting capacity with bundle cutting	Max. 340x250 mm - Min. 130x10 mm - Scrap-end: 280mm
Minimum cutting length	15 mm
Blade size	3730x34x1.1mm
Canted blade	0°
Blade motor	3 KW
Feeder length	500 mm
Feeder motor power	0.75 KW
Minimum scrap-end	90 mm
Blade speed	15/100 m/min
Hydraulic unit motor power	0.75 KW
Hydraulic unit tank capacity	20 l
Coolant tank capacity	50 l
Size - Weight - Working area height	1950x1755x1965mm - 1650kg - 920mm

Features



7" touch screen display

XSMART3 has an easy, intuitive and user-friendly interface with a 7" touch screen display that allows to have full control on all the machine parameters and all the operative settings. Using CNC system, the user will have the possibility to optimize his user-experience and workflow with just few clicks. These features, combined with the solid structure, make XSMART3 the perfect working tool for industry application.



Sawframe

XSMART3 sawframe has an elctrowelded rigid structure on double column which helps reduce vibrations and binding during descent. Like many IMET bandsaws, its blade is canted (30°) to reduce the band strain and have better and constant sawframe descent while cutting with optimized performances on every material, profiles or solid.

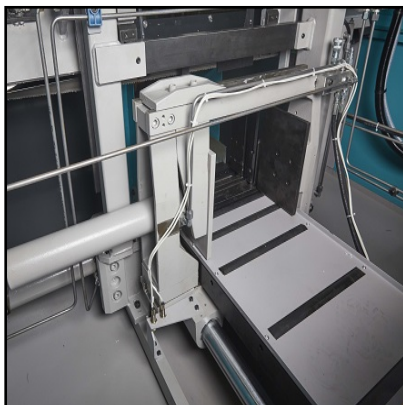

Feeder with roller table

XSMART feeder has a single stroke of 500mm with integrated roller table for material support. The feeder moves with a recyrculatig screw and electric motor with inverter, portal structure that ease material movement and loading.

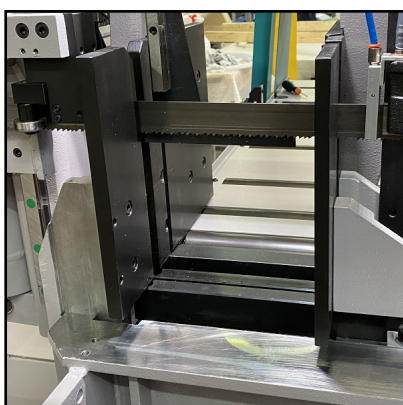

Full stroke vice

The machines uses an hydraulic full stroke vice to lock the material with jaws place both before and after the cutting line.

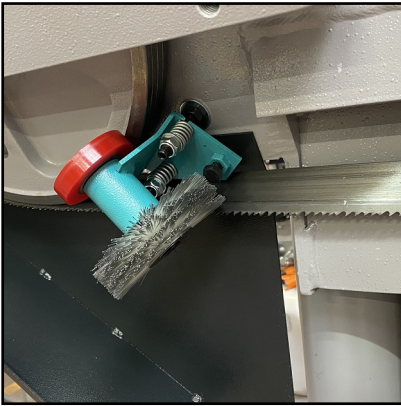

Blade cleaning

All the semiautomatic and automatic IMET bandsaws are equipped with a mechanical cleaning brush with nylon fibers that helps to remove residuals and remainings while cutting.



Washing gun

Premium Line automatic bandsaws and semiautomatic and automatic Maxi Line bandsaws are standardly equipped with a washing gun dedicated to keep clean the working area and remove any residuals and remainings, allowing to keep the highest efficiency of the machine.

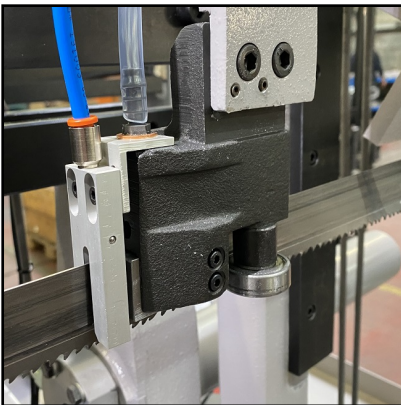

Blade guide

Hard metal blade guides with bearings to have an optimal blade alignment during the cutting process. The mobile blade guide is kept automatically next the cutting point.



Chips conveyor

Standard on XSMART3 there's a chip conveyor that helps remove any material remaining while the machine works.

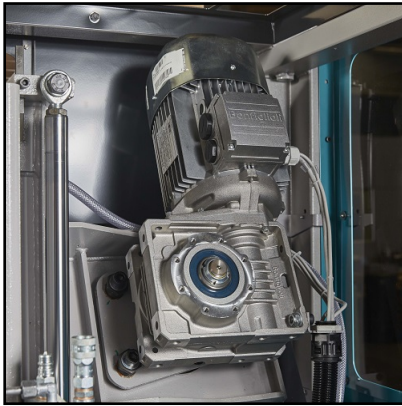

Bonfiglioli motor-reducer

XSMART3 uses Bonfiglioli motor-reducer to have the highest reliability and functionality.

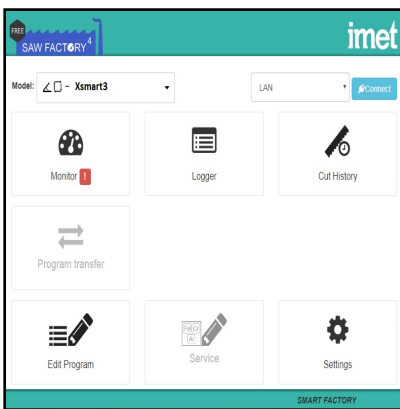

Industry 4.0 Ready - SAWFACTORY (optional)

OPTIONAL

IMET automatic machines can be connected to the company network and be used remotely thanks SAWFACTORY and modem. SAWFACTORY is a dedicated software which allows to manage the cutting process from the office desk by setting cutting programs and monitoring the workflow thanks to the dedicated web app. The software also allows to also receive assistance by our technicians remotely. Discover SAWFACTORY: <https://bit.ly/2RuxHuX>



Minimal lubrication system (optional)

OPTIONAL

It is possible to require, for all Imet machines, the minimal lubrication system, it avoids the dispersion of refrigerant liquid typical in the use of emulsifiable oil, the life of the blade is not in any way o affected. Minimal lubrication system for XSMART3 has a 1.3 l tank capacity.



Pressure regulation (Optional)

OPTIONAL

It's possible to add two supplementary pressure reducers to regulate both machine's vices (feeder vice and the fix vice) in order to cut even the shorter length.



Laser ray (optional)

OPTIONAL

Laser ray to optimize the working process of the operator that helps to view the set cutting line.



Deluxe Kit (optional)

OPTIONAL

Deluxe Kit is an available optional dedicated to increase the user-experience and optimize the professional user workflow: it includes the blade deviation control system, the smart start system to set trim cut quote and sawframe descent speed view on machine display.

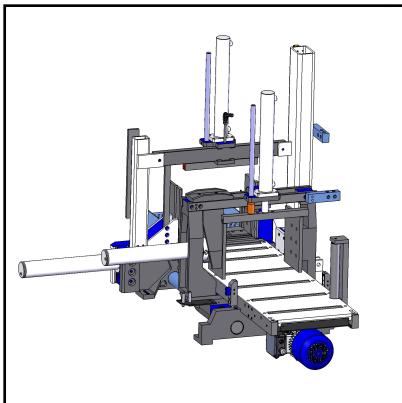

Bundle cutting device (Optional)

OPTIONAL

It's possible to require the hydraulic device for bundle cutting which takes cutting capacity at 340x250mm maximum and 130x10mm minimum while bundle cutting scrap-end is 280mm.

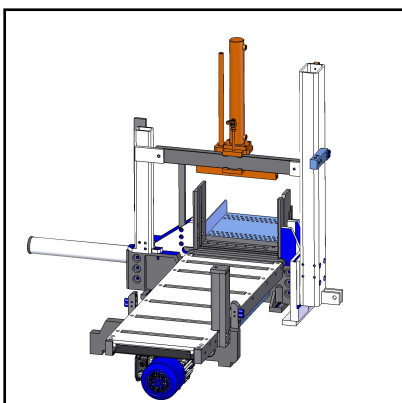

How to use bundle device (Optional)

OPTIONAL

It's possible to use the bandsaw also for the cut of a single piece (minimum diameter 110mm) even with the bundle device already assembled: the user must disconnect the tubes that connect the two bundle piston (thanks to the fast graftings) and move the vertical pistons and bundle group laterally next to the vice. Also the horizontal plate, located on the fixed vice, must be removed (by two screws); with Deluxe Kit, capacity: 60mm.

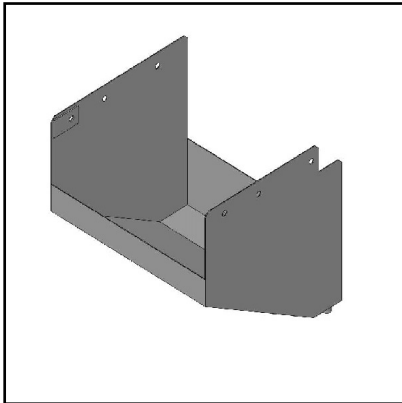

Connection element for loading side (Optional) OPTIONAL

Connection element for loading side between machine and loading roller table.



Loading/Loading roller table - First elemento (optional) OPTIONAL

Loading and unloading roller table with free rolls. First element, single module 2m length.



Loading/unloading roller table - next elements (Optional) OPTIONAL

Loading and unloading roller table with free rolls. Next elements, single module length is 2m.



Pair of vertical roller table (Optional) OPTIONAL

Pair of vertical containment roller table made in steel and 400mm height. Max 2 pairs for each 2m roller table